

- NOTES:
- MATERIAL: 316L STAINLESS STEEL, NICKEL BRAZED.
 - PRODUCT CONTACT SURFACE FINISH CODE PER ASME-BPE:
SF1: 20 µin. (.5 µm) Ra MAX
SF4: 15 µin. (.4 µm) Ra MAX, ELECTROPOLISHED.
 - ALL EXTERNAL SURFACES SATIN FINISH.
 - MAXIMUM OPERATING CONDITIONS:
 - PRESSURE: TUBESIDE - 375 psi (25 bar)
SHELLSIDE - 300 psi (20 bar)
(REFER TO SANITARY CLAMP MANUFACTURER FOR CLAMP PRESSURE RATING)
 - TEMPERATURE: 800°F (425°C)
 - PRESSURE FOR STEAM SERVICE: 125 psi (8.6 bar)
 - FLUID TEMPERATURE DIFFERENCE:
 $(T_{HOT})_{AVE} - (T_{COLD})_{AVE} \leq 125^{\circ}F (70^{\circ}C)$
 - FULLY DRAINABLE ON TUBESIDE.
 - MATERIAL AND PROCESS CERTIFICATIONS PROVIDED.

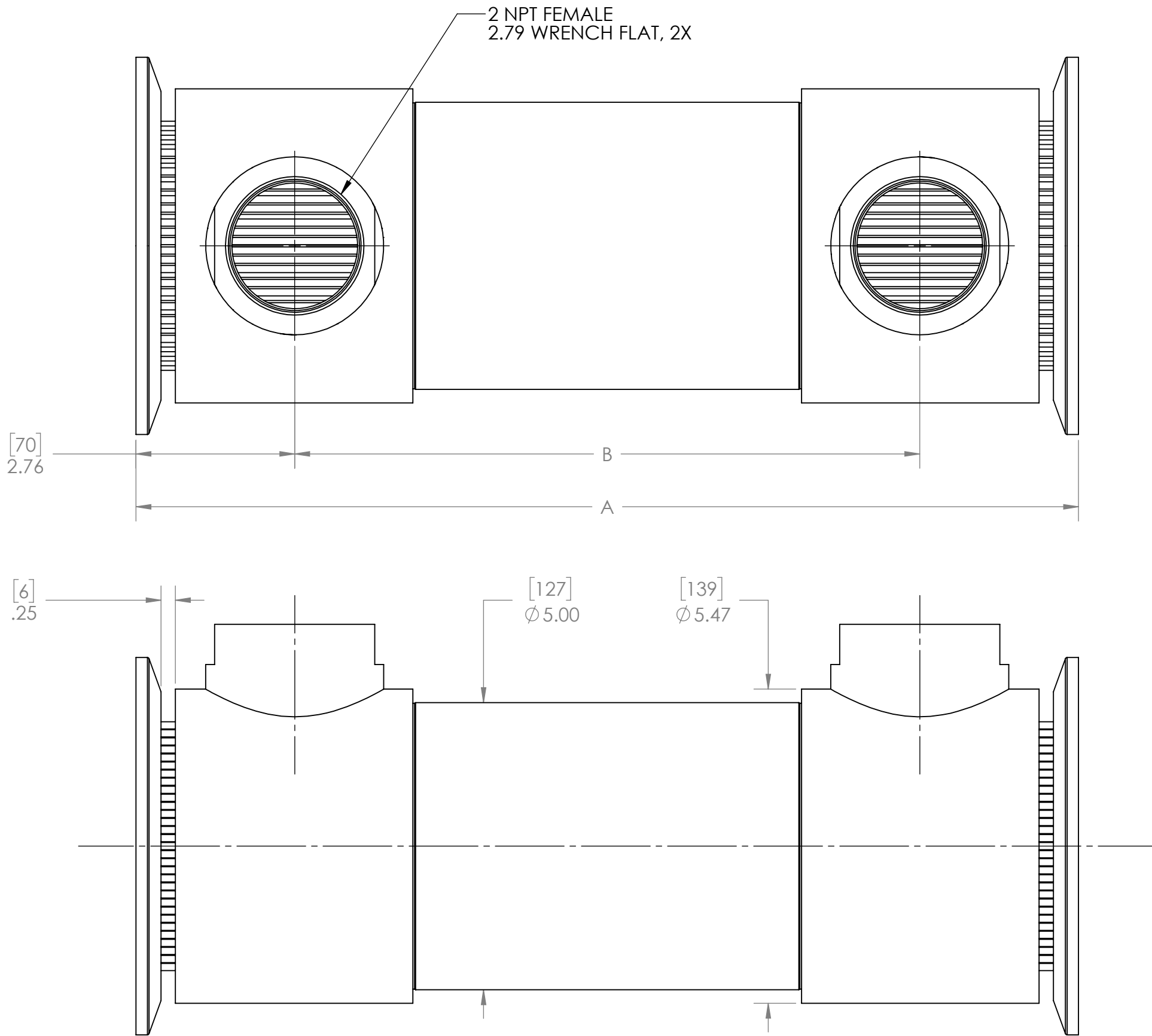

- #	TUBE COUNT	TUBE SIZE	PRODUCT CONTACT SURFACE FINISH (NOTE 2)	DIM A		DIM B		WEIGHT EMPTY		TRANSFER AREA	
				in	mm	in	mm	lb	kg	ft²	m²
- 01	649	1/8" [3.2] X .012 [.32] WALL	SF4	11.41	290	5.886	150	35.16	15.95	16.69	1.55
- 02				16.41	417	10.886	277	43.54	19.75	25.54	2.37
- 03				21.41	544	15.886	404	51.87	23.53	34.39	3.20
- 04				26.41	671	20.886	531	60.20	27.31	43.24	4.02
- 05				31.41	798	25.886	658	68.80	31.21	52.09	4.84
- 06			SF1	41.41	1052	35.886	912	85.20	38.65	69.79	6.48
- 07				11.41	290	5.886	150	35.16	15.95	16.69	1.55
- 08				16.41	417	10.886	277	43.54	19.75	25.54	2.37
- 09				21.41	544	15.886	404	51.87	23.53	34.39	3.20
- 10				26.41	671	20.886	531	60.20	27.31	43.24	4.02
- 11	253	3/16" [4.8] X .020 [.5] WALL	SF4	31.41	798	25.886	658	68.80	31.21	52.09	4.84
- 12				41.41	1052	35.886	912	85.20	38.65	69.79	6.48
- 13				11.41	290	5.886	150	34.40	15.60	9.76	0.91
- 14				16.41	417	10.886	277	42.23	19.15	14.94	1.39
- 15				21.41	544	15.886	404	50.00	22.68	20.11	1.87
- 16			SF1	26.41	671	20.886	531	57.77	26.21	25.29	2.35
- 17				31.41	798	25.886	658	65.55	29.73	30.46	2.83
- 18				41.41	1052	35.886	912	81.09	36.78	40.81	3.79
- 19				11.41	290	5.886	150	34.40	15.60	9.76	0.91
- 20				16.41	417	10.886	277	42.23	19.15	14.94	1.39
- 21	185	1/4" [6.4] X .035 [.9] WALL	SF4	21.41	544	15.886	404	50.00	22.68	20.11	1.87
- 22				26.41	671	20.886	531	57.77	26.21	25.29	2.35
- 23				31.41	798	25.886	658	65.55	29.73	30.46	2.83
- 24				41.41	1052	35.886	912	81.09	36.78	40.81	3.79
- 25			SF1	11.41	290	5.886	150	39.48	17.91	9.52	0.88
- 26				16.41	417	10.886	277	49.85	22.61	14.56	1.35
- 27				21.41	544	15.886	404	60.50	27.44	19.61	1.82
- 28				26.41	671	20.886	531	70.83	32.13	24.65	2.29
- 29				31.41	798	25.886	658	80.84	36.67	29.70	2.76
- 30			SF4	41.41	1052	35.886	912	101.50	46.04	39.79	3.70
- 31	36		SF1	11.41	290	5.886	150	39.48	17.91	9.52	0.88
- 32				16.41	417	10.886	277	49.85	22.61	14.56	1.35
- 33				21.41	544	15.886	404	60.50	27.44	19.61	1.82
- 34				26.41	671	20.886	531	70.83	32.13	24.65	2.29
- 35				31.41	798	25.886	658	80.84	36.67	29.70	2.76
- 36			SF4	41.41	1052	35.886	912	101.50	46.04	39.79	3.70
- 37											

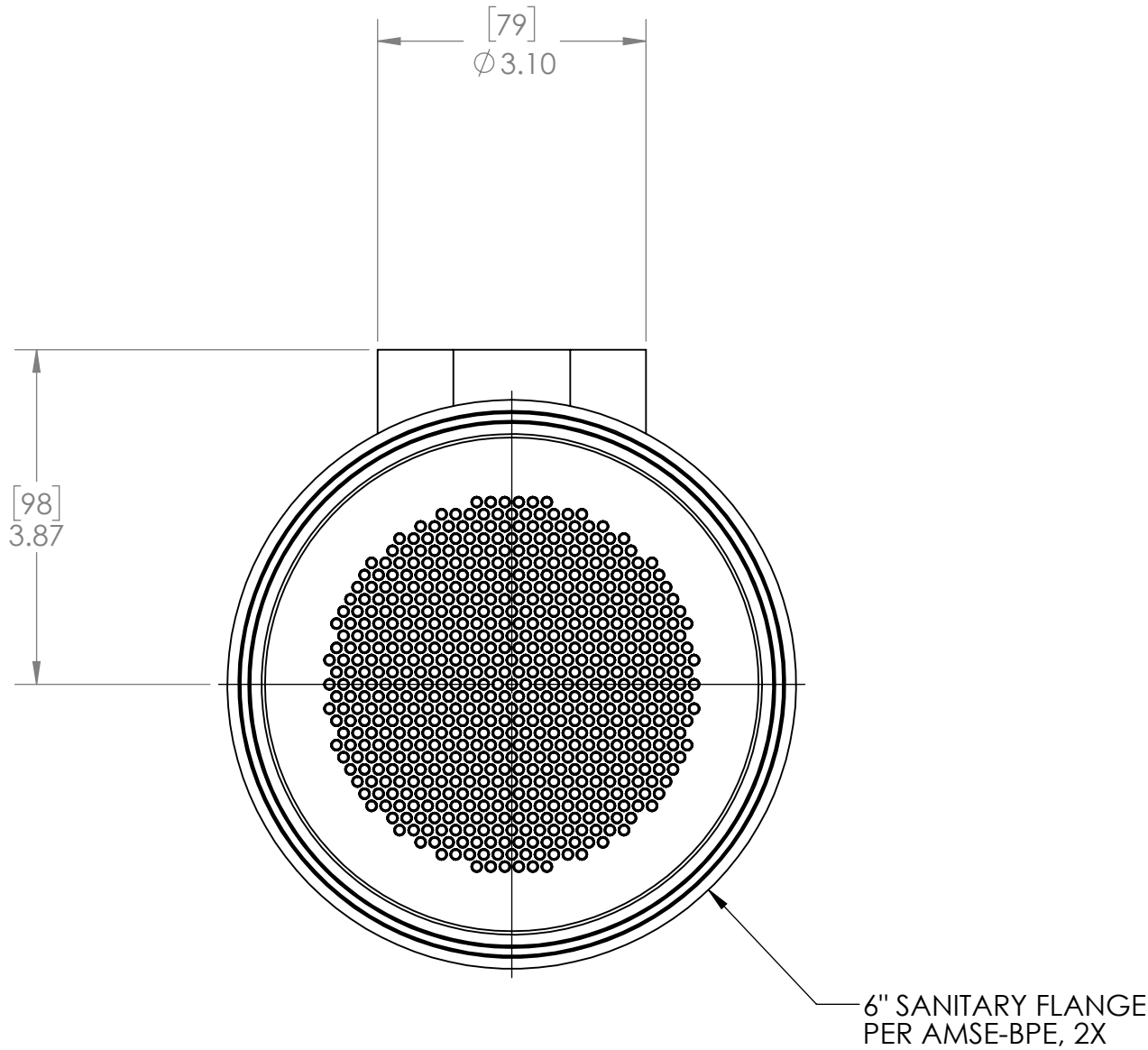

PROPRIETARY AND CONFIDENTIAL
THE INFORMATION CONTAINED IN THIS DOCUMENT IS THE SOLE PROPERTY OF EXERGY, LLC. ANY REPRODUCTION, DISCLOSURE, OR USE, IN PART OR AS A WHOLE, WITHOUT THE WRITTEN PERMISSION OF EXERGY, LLC IS PROHIBITED.

PRODUCT SPECIFICATIONS SUBJECT TO CHANGE WITHOUT NOTICE. MANUFACTURER ASSUMES NO LIABILITY FOR MISUSE OR ABUSE OF PRODUCT. SPECIFIC WARRANTY INFORMATION IS AVAILABLE UPON REQUEST.

THIRD ANGLE PROJECTION



EXERGY
HEAT TRANSFER SOLUTIONS
320 ENDO BLVD.
GARDEN CITY, NY 11530
USA
www.exergyinc.com

**SHELL & TUBE HEAT EXCHANGER
120 SERIES SANITARY
DOUBLE TUBESHEET, 2" NPT**

MODEL NO. **04125 - #**

DATE **4/15/2019** SCALE **1:2** SHEET **1 OF 1**